



Growth & Planning Committee Meeting January 22, 2024

Submitted by: Cecilia Davis
Deputy Superintendent of Innovations, Business
and Operations
Daniel Brooks, Assistant Superintendent for
Operations
Benjamin S. Mora, Executive Director of Facilities
Planning
Ruben Moreno, Director of Facilities Planning
Pollyanne Johnson, Assistant Director of Facilities
Planning

2022 Bond

Elementary School #21 New Construction

Middle School #6 New Construction





Agenda

- I. Welcome & Introductions
 - Deputy Superintendent of Innovations, Business and Operations
 - Daniel Brooks, Assistant Superintendent for Operations
 - Benjamin S. Mora, Executive Director of Facilities Planning
 - Ruben Moreno, Director of Facilities Planning
 - Pollyanne Johnson, Assistant Director of Facilities Planning
- II. Elementary #21
- III. Middle School #6
- IV. Bond 2022 Update
- V. The Road Ahead for Judson
- VI. Conclusion



Elementary School #21

Designer: Alamo Architects

Board Approved: 12/15/2022

Contractor: To Be Determined

Board Approved: To Be Determined

- The scope of work consists of a new Elementary School and associated sitework. The new facility is in the City of Selma.
- Construction Documents are 100% complete. The project is planned to bid before the end of November as a request for competitive sealed proposals. Award is tentatively scheduled for the January 18, 2024, Judson board of trustees meeting.

Estimated Completion: Anticipated school opening Summer 2025.





Elementary School #21

Site Clearing & Haul Away

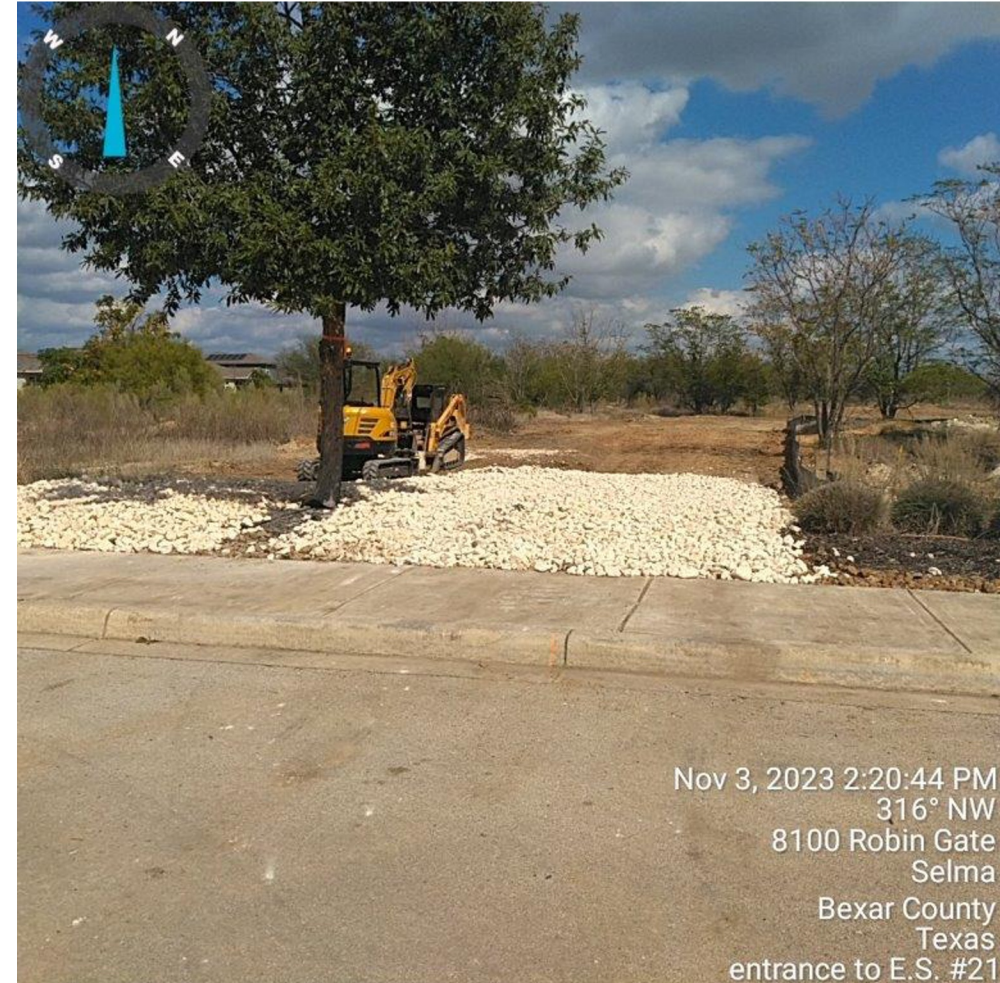

Elementary School #21





Middle School #6

Designer: Pfluger Architects
Board Approved: 06/03/2021
Contractor: SpawGlass
Board Approved: 03/28/2023

- This is the construction of a new middle school facility to include building and site work.
- The retaining walls are continuing to be constructed. Currently placing rebar on the vertical surface of the pier in preparation of spray concrete.
- In Area F and E, the plumbing has been installed and the foundation concrete has been poured.
- Rough grading at parent pick-up / parking lot still ongoing.
- Storm drain and utility improvements have begun

Estimated Completion: Anticipated school opening Summer 2025



Middle School #6 – Foundation Preparation & Progress





Judson independent school district
Facilities Planning Department

Middle School #6 – Structural Steel & CMU Blocks





The Road Ahead for Judson

- Demographic and economic trends suggests that Judson continues to buck the local inner-city growth pattern
- While development is evident throughout the District, the northern areas are seeing accelerated, new residential construction
- Kitty Hawk & Metzger MS's capacity continues to creep upward with maximum capacity being reached in the next 3 to 4 years
- In the next 7 years Wagner HS will be near capacity

Conclusions

- Judson's total Enrollment is forecast to be 25,000 students in 5 years
- Judson's facility capacity will need to keep pace due to student demand
- Judson enjoys the popular support and will continue to engage and inform the community through open channels



Judson independent school district
Facilities Planning Department

Thank You

Feedback & Questions?